

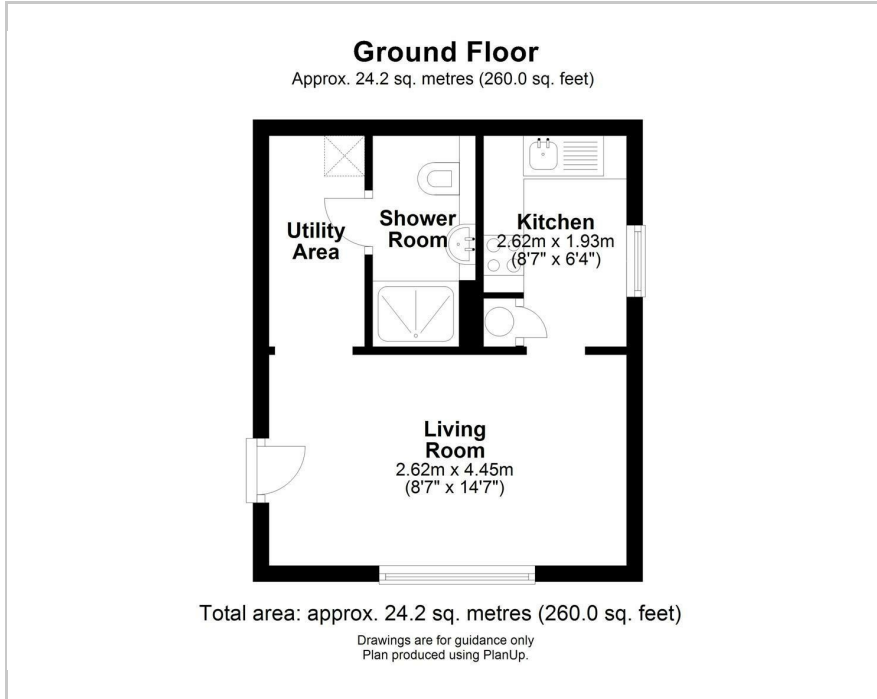

83 Corrie Road, Cambridge, CB1 3QQ
£1,050 Per month

 1  1  1  C

Floor Plan



Accommodation

- Excellent location
- Refurbished throughout
- Off-street parking

Completely refurbished ground floor studio flat in a purpose built development. Available unfurnished, the property is in an excellent location, being within walking distance of the rail station and close to both Mill Road and Cherry Hinton Road which are both bursting with amenities such as cafes, restaurants and lots of diverse independent shops as well as the more well-known supermarkets.

The property has been recently redecorated. The main living area is nice and light and overlooks the small garden area at the front. There is a re-fitted kitchen with oven and fridge and a separate useful utility/storage area with a washing machine, which leads to the refitted shower room.

There is off street parking and the heating is electric. Single occupancy only.

EPC Rating: C. Council Tax Band: A.

///heats.track.epic

Viewing

Please contact our Gray & Toynbee - Cambridge Office on 01223 439 888 if you wish to arrange a viewing appointment for this property or require further information.

Energy Efficiency Graph

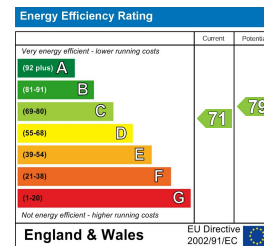

Area Map

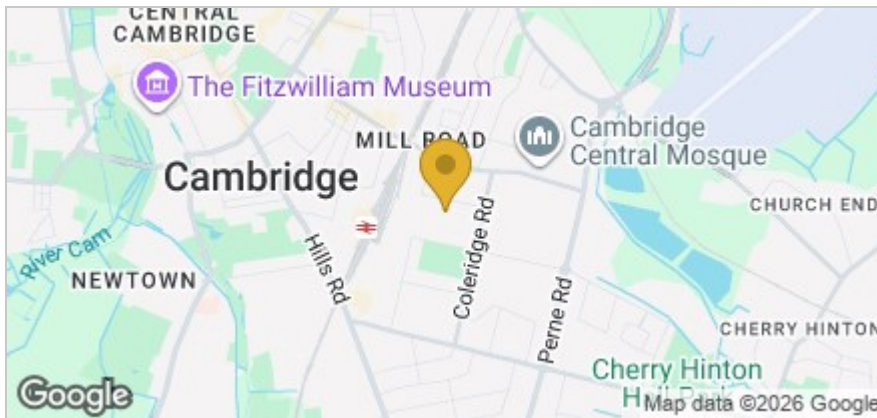

These particulars, whilst believed to be accurate are set out as a general outline only for guidance and do not constitute any part of an offer or contract. Intending purchasers should not rely on them as statements of representation of fact, but must satisfy themselves by inspection or otherwise as to their accuracy. No person in this firm's employment has the authority to make or give any representation or warranty in respect of the property.

154-156 Victoria Road, Cambridge, CB4 3DZ
Tel: 01223 439 888 Email: theteam@grayandtoynbee.com